



Specified Fittings, LLC

164 West Smith Road • PO Box 28157 • Bellingham, WA 98228-0157 | Email: sales@specfit.com

Bellingham: 360-398-7700 | 360-398-7051 Fax
Stevensville: 406-777-3466 | 406-777-7181 Fax
Mexico (Toll Free): 800-429-1705 | 800-574-1075 Fax

SIGNED DRAWINGS MUST ACCOMPANY PURCHASE ORDER OR DIMENSIONS OF FITTINGS WILL NOT BE GUARANTEED

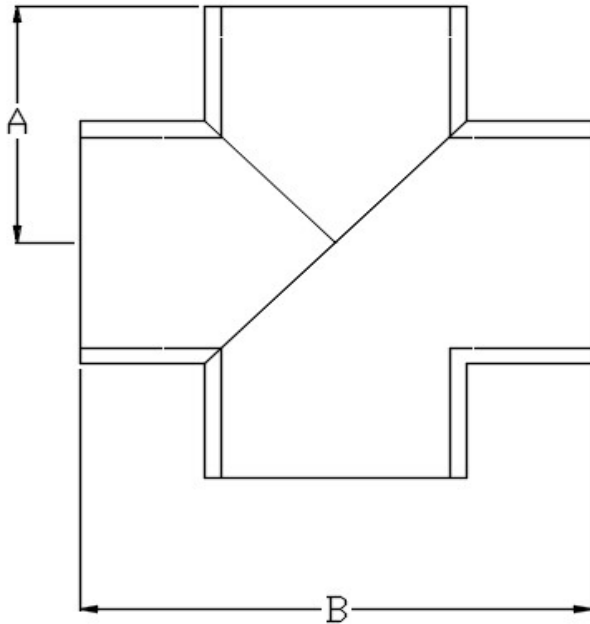

SIZE	A	B
4	7.5	15
6	10.375	20.75
8	11.875	23.75
10	13.125	26.25
12	15.375	30.75
14	16	32
16	17	34
18	19	38
20	20	40
24	24	48
30	35.5	71
36	38.5	77
42	41.5	83
48	44.5	89

DISCLAIMER - PLEASE READ

- 1) All dimensions approximate, subject to change without notice
--Angle tolerance is +/- 2 degrees
--All other dimensions to +/- 1"
- 2) This drawing only applicable if a copy is referenced at time of order.
--Without a copy of drawing, fitting construction may differ from that shown.
- 3) Subject to Specified Fittings Standard Terms and Conditions.

5/26/2020

Description: CROSS

Material: HDPE 4710

Size: DIPS

Configuration: DIPS PLAIN ENDS

SALES	
CAD TECH	DE