



CSA
Group



Specified Fittings, LLC

164 West Smith Road • PO Box 28157 • Bellingham, WA 98228-0157 | Email: sales@specfit.com

Bellingham: 360-398-7700 | 360-398-7051 Fax
Stevensville: 406-777-3466 | 406-777-7181 Fax
Mexico (Toll Free): 800-429-1705 | 800-574-1075 Fax

SIGNED DRAWINGS MUST ACCOMPANY PURCHASE ORDER OR DIMENSIONS OF FITTINGS WILL NOT BE GUARANTEED

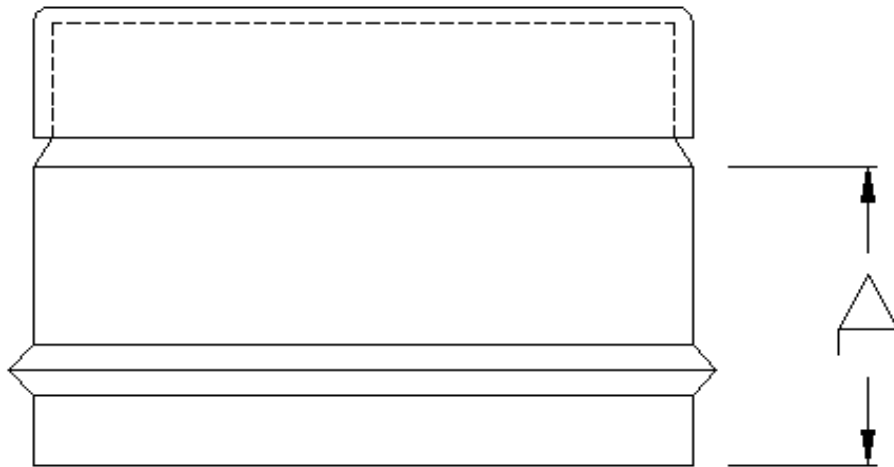

SIZE	A
4"	4.5
6"	4
8"	5
10"	5.5
12"	6.5
15"	8.5
18"	9.25
21"	10.25
24"	11.5
27"	12.5
30"	15.5
36"	17
42"	21
48"	20

DISCLAIMER - PLEASE READ

Description: GASKETED CAP
 Material: PVC SDR 35
 Part #'s: 79190(4-48)
 Configuration: GASKET X END CAP

- 1) All dimensions approximate, subject to change without notice
 --Angle tolerance is +/- 2 degrees
 --All other dimensions to +/- 1"
- 2) This drawing only applicable if a copy is referenced at time of order.
 --Without a copy of drawing, fitting construction may differ from that shown.
- 3) Subject to Specified Fittings Standard Terms and Conditions.