

Specified Fittings, LLC

164 West Smith Road • PO Box 28157 • Bellingham, WA 98228-0157 | Email: sales@specfit.com

Bellingham: 360-398-7700 | 360-398-7051 Fax

Stevensville: 406-777-3466 | 406-777-7181 Fax

Mexico (Toll Free): 800-429-1705 | 800-574-1075 Fax

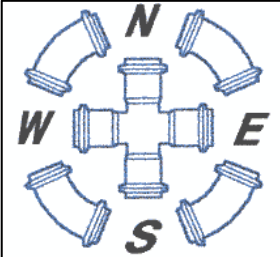

SIGNED DRAWINGS MUST ACCOMPANY PURCHASE ORDER OR DIMENSIONS OF FITTINGS WILL NOT BE GUARANTEED

DISCLAIMER - PLEASE READ

- 1) All dimensions approximate, subject to change without notice
--Angle tolerance is +/- 2 degrees
--All other dimensions to +/- 1"
- 2) This drawing only applicable if a copy is referenced at time of order.
--Without a copy of drawing, fitting construction may differ from that shown.
- 3) Subject to Specified Fittings Standard Terms and Conditions.

Figure A

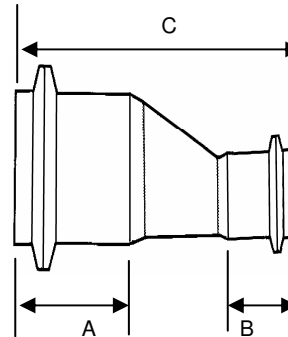
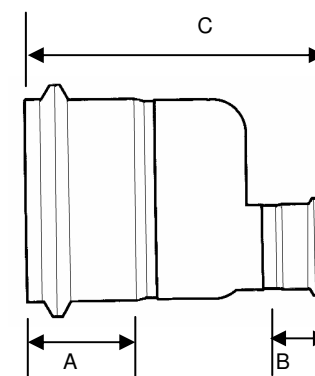

Figure B



Description:	Eccentric Reducer
Material:	SDR26 Heavy Wall Sewer
Size:	See Chart
Configuration:	Gasket x Gasket

GASKETED HEAVY WALL SEWER ECCENTRIC REDUCERS

SIZE				10X4	10X6	10X8*	12X4	12X6	12X8	12X10*	15X4	15X6
A				6	6	6	6.5	6.5	6.5	6.5	8	8
B				3.5	4.5	5	3.5	4.5	5	6	3.5	4.5
C				15	17.75	15	16	18.75	19.75	16.5	18.5	21

SIZE	15X8	15X10	15X12	18X4	18X6	18X8	18X10	18X12	18X15	21X4	21X6	21X8
A	8	8	8	9.25	9.25	9.25	9.25	9.25	9.25	11.25	11.25	11.25
B	5	6	6.5	3.5	4.5	5	6	6.5	8	3.5	4.5	5
C	22.25	23.5	24.5	20.25	23	24	25.5	26.25	28.75	22.25	24.75	26

SIZE	21X10	21X12	21X15	21X18	24X4	24X6	24X8	24X10	24X12	24X15	24X18	24X21
A	11.25	11.25	11.25	11.25	12.5	12.5	12.5	12.5	12.5	12.5	12.5	12.5
B	6	6.5	8	9.25	3.5	4.5	5	6	6.5	8	9.25	11.25
C	27.5	28.25	30.5	32.5	23.5	26	27.25	28.5	29	31.75	33	35.25

SIZE	27X4	27X6	27X8	27X10	27X12	27X15	27X18	27X21	27X24	30X4	30X6	30X8
A	13.5	13.5	13.5	13.5	13.5	13.5	13.5	13.5	13.5	19.5	19.5	19.5
B	3.5	4.5	5	6	6.5	8	9.25	11.25	12.5	3.5	4.5	5
C	25	27.75	28.75	30.25	31.25	33.5	35.25	37	38	31.25	34	35

SIZE	30X10	30X12	30X15	30X18	30X21	30X24	30X27	36X4	36X6	36X8	36X10	36X12
A	19.5	19.5	19.5	19.5	19.5	19.5	19.5	17.5	17.5	17.5	17.5	17.5
B	6	6.5	8	9.25	11.25	12.5	13.5	3.5	4.5	5	6	6.5
C	36.5	37.5	39.75	41.5	43.25	44.5	46	29.25	32	33	34.5	35.5

SIZE	36X15	36X18	36X21	36X24	36X27	36X30
A	17.5	17.5	17.5	17.5	17.5	17.5
B	8	9.25	11.25	12.5	13.5	19.5
C	37.75	39.5	41.25	42.5	44	51

PLEASE NOTE: ALL FITTINGS DESIGNATED WITH A STAR ARE TO BE MADE "ONE-PIECE" AS SHOWN IN FIGURE A. ALL OTHER FITTINGS WILL BE MADE "TWO-PIECE" AS SHOWN IN FIGURE B.