



Specified Fittings, LLC

164 West Smith Road • PO Box 28157 • Bellingham, WA 98228-0157 | Email: sales@specfit.com

Bellingham: 360-398-7700 | 360-398-7051 Fax

Stevensville: 406-777-3466 | 406-777-7181 Fax

Mexico (Toll Free): 800-429-1705 | 800-574-1075 Fax



TYPE A

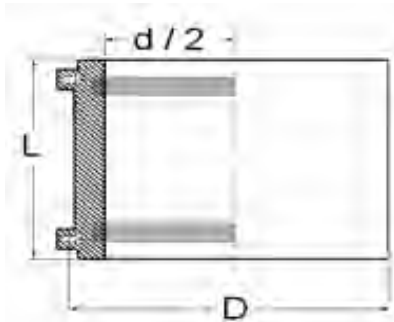

TYPE B

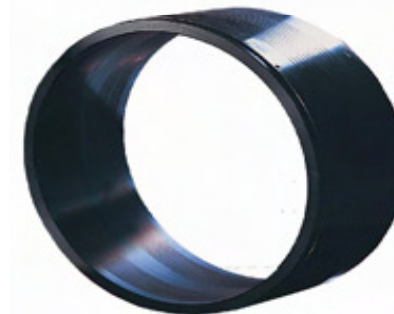
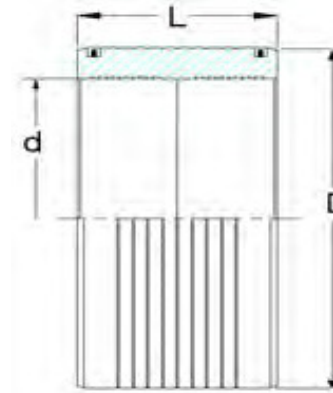

Description: IPS HDPE MOLDED
ELECTROFUSION COUPLINGS

Material: HDPE

Size: 2" - 24"
CLASS 150, CLASS 200

PSI RATINGS 150, 200

NOTE:

Molded fittings are manufactured and tested to the requirements of ASTM D3035, D3261, AWWA C901 or C906, and FM 1613. These fittings are tested to the requirements of ASTM D3261 and are compatible for heat fusion with any pipe and or fitting of compatible resin. Made from PE3408/3608 or PE4710 material. All raw material shall comply with NSF-61. Other OD's, SDR's and Pressure Ratings available upon request. Per FM 1613 and AWWA C906, the working pressure rating equals the pressure class with an allowance included in the WPR for pressure surge.

FOR DISCLAIMER REFER TO FM DIMENSION CATALOG.

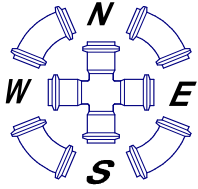

SPECIFIED FITTINGS, INC

164 W. SMITH RD
BELLINGHAM, WA 98226
888-734-8846 (T)
888-734-8258 (F)
spec@specfit.com

483 STEVENSVILLE AIRPORT RD.
STEVENSVILLE, MT 59870
406-777-3466 (T)
406-777-7181 (F)
sales@specfit.com

www.specfit.com

ELECTROFUSION COUPLINGS DIMENSION CHART

PIPE SIZE	d & d/2	D	L	TYPE	PRESSURE	
					CLASS	PART #
2" IPS	2.375	3.15	4.21	A	150	MHD2452FM150
2" IPS	2.375	3.15	4.21	A	200	MHD2452FM200
3" IPS	3.5	4.53	5.91	A	150	MHD2453FM150
3" IPS	3.5	4.53	5.91	A	200	MHD2453FM200
4" IPS	4.5	5.59	6.69	A	150	MHD2454FM150
4" IPS	4.5	5.59	6.69	A	200	MHD2454FM200
5" IPS	5.563	7.09	6.73	A	150	MHD2455FM150
5" IPS	5.563	7.09	6.73	A	200	MHD2455FM200
6" IPS	6.625	8.07	7.28	B	150	MHD2456FM150
6" IPS	6.625	8.07	7.28	B	200	MHD2456FM200
8" IPS	8.625	10.83	8.03	B	150	MHD2458FM150
8" IPS	8.625	10.83	8.03	B	200	MHD2458FM200
10" IPS	10.75	13.58	8.66	B	150	MHD24510FM150
10" IPS	10.75	13.58	8.66	B	200	MHD24510FM200
12" IPS	12.75	17.52	9.06	B	150	MHD24512FM150
12" IPS	12.75	17.52	9.06	B	200	MHD24512FM200
14" IPS	14	19.49	10	B	150	MHD24514FM150
14" IPS	14	19.49	10	B	200	MHD24514FM200
16" IPS	16	21.81	11.81	B	150	MHD24516FM150
16" IPS	16	21.81	11.81	B	200	MHD24516FM200
18" IPS	18	24.21	12.6	B	150	MHD24518FM150
18" IPS	18	24.21	12.6	B	200	MHD24518FM200
20" IPS	20	27.17	14.41	B	150	MHD24520FM150
20" IPS	20	27.17	14.41	B	200	MHD24520FM200
22" IPS	22	29.72	15.75	B	150	MHD24522FM150
22" IPS	22	29.72	15.75	B	200	MHD24522FM200
24" IPS	24	29.72	15.75	B	150	MHD24524FM150
24" IPS	24	29.72	15.75	B	200	MHD24524FM200