



# Specified Fittings, LLC

164 West Smith Road • PO Box 28157 • Bellingham, WA 98228-0157 | Email: sales@specfit.com

Bellingham: 360-398-7700 | 360-398-7051 Fax

Stevensville: 406-777-3466 | 406-777-7181 Fax

Mexico (Toll Free): 800-429-1705 | 800-574-1075 Fax

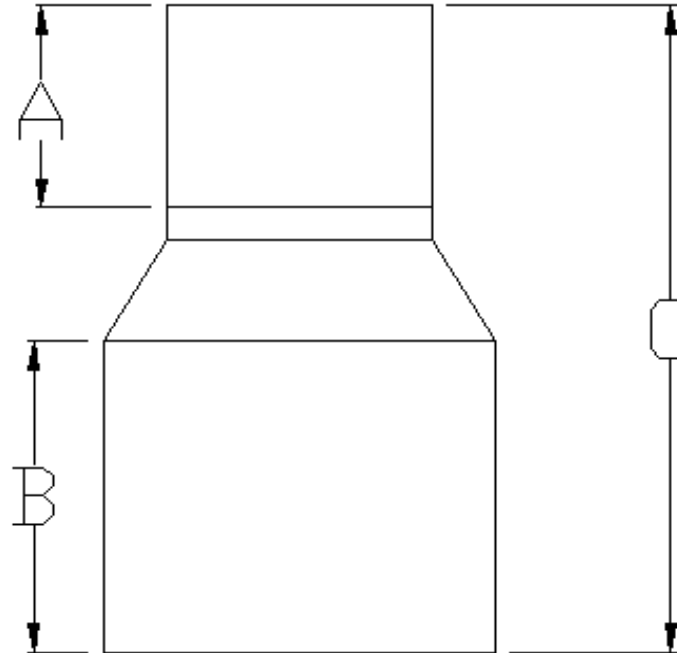

Description: DIPS HDPE FABRICATED CONCENTRIC REDUCERS (PLAIN-ENDS)  
Material: HDPE  
Size: 6" - 24"  
CLASS 150, CLASS 200  
PSI RATINGS 150, 200

**NOTE:**

Fittings are manufactured and tested to the requirements of ASTM D3035, D3261, AWWA C901 or C906, and FM 1613. These fittings are tested to the requirements of ASTM D3261 and are compatible for heat fusion with any pipe and or fitting of compatible resin. Made from PE3408/3608 or PE4710 material. All raw material shall comply with NSF-61. Other OD's, SDR's and Pressure Ratings available upon request. Per FM 1613 and AWWA C906, the working pressure rating equals the pressure class with an allowance included in the WPR for pressure surge.  
FOR DISCLAIMER REFER TO FM DIMENSION CATALOG.

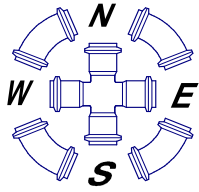

# SPECIFIED FITTINGS, INC

**164 W. SMITH RD**  
**BELLINGHAM, WA 98226**  
**888-734-8846 (T)**  
**888-734-8258 (F)**  
[spec@specfit.com](mailto:spec@specfit.com)

**483 STEVENSVILLE AIRPORT RD.**  
**STEVENSVILLE, MT 59870**  
**406-777-3466 (T)**  
**406-777-7181 (F)**  
[sales@specfit.com](mailto:sales@specfit.com)

[www.specfit.com](http://www.specfit.com)

## DIPS HDPE FABRICATED CONCENTRIC REDUCER DIMENSION CHART

SIZE	A	B	C	PRESSURE	
				CLASS	PART #
6X4	4.75	7	15.25	150	HDS60064FM150DIPS
6X4	4.75	7	15.25	200	HDS60064FM200DIPS
8X4	4.75	7.5	20.25	150	HDS60084FM150DIPS
8X4	4.75	7.5	20.25	200	HDS60084FM200DIPS
8X6	6.75	7.5	17.75	150	HDS60086FM150DIPS
8X6	6.75	7.5	17.75	200	HDS60086FM200DIPS
10X4	4.75	7.5	22.25	150	HDS600104FM150DIPS
10X4	4.75	7.5	22.25	200	HDS600104FM200DIPS
10X6	6.75	7.5	18.5	150	HDS600106FM150DIPS
10X6	6.75	7.5	18.5	200	HDS600106FM200DIPS
10X8	7.25	7.5	18	150	HDS600108FM150DIPS
10X8	7.25	7.5	18	200	HDS600108FM200DIPS
12X4	4.75	11	29	150	HDS600124FM150DIPS
12X4	4.75	11	29	200	HDS600124FM200DIPS
12X6	6.75	11	26.75	150	HDS600126FM150DIPS
12X6	6.75	11	26.75	200	HDS600126FM200DIPS
12X8	7.25	11	21.5	150	HDS600128FM150DIPS
12X8	7.25	11	21.5	200	HDS600128FM200DIPS
12X10	7	11	19.75	150	HDS6001210FM150DIPS
12X10	7	11	19.75	200	HDS6001210FM200DIPS
14X4	4.75	11	33	150	HDS600144FM150DIPS
14X4	4.75	11	33	200	HDS600144FM200DIPS
14X6	6.75	11	26.75	150	HDS600146FM150DIPS
14X6	6.75	11	26.75	200	HDS600146FM200DIPS
14X8	7.25	11	26	150	HDS600148FM150DIPS
14X8	7.25	11	26	200	HDS600148FM200DIPS
14X10	7	11	21.75	150	HDS6001410FM150DIPS
14X10	7	11	21.75	200	HDS6001410FM200DIPS

SIZE	A	B	C	PRESSURE	
				CLASS	PART #
14X12	8.5	11	22.5	150	HDS6001412FM150DIPS
14X12	8.5	11	22.5	200	HDS6001412FM200DIPS
16X4	4.75	11	34.75	150	HDS600164FM150DIPS
16X4	4.75	11	34.75	200	HDS600164FM200DIPS
16X6	6.75	11	28.5	150	HDS600166FM150DIPS
16X6	6.75	11	28.5	200	HDS600166FM200DIPS
16X8	7.25	11	26.25	150	HDS600168FM150DIPS
16X8	7.25	11	26.25	200	HDS600168FM200DIPS
16X10	7	11	23.5	150	HDS6001610FM150DIPS
16X10	7	11	23.5	200	HDS6001610FM200DIPS
16X12	8.5	11	23.25	150	HDS6001612FM150DIPS
16X12	8.5	11	23.25	200	HDS6001612FM200DIPS
16X14	8.5	11	21.25	150	HDS6001614FM150DIPS
16X14	8.5	11	21.25	200	HDS6001614FM200DIPS
18X4	4.625	12	40	150	HDS600184FM150DIPS
18X4	4.625	12	40	200	HDS600184FM200DIPS
18X6	6.75	12	36.75	150	HDS600186FM150DIPS
18X6	6.75	12	36.75	200	HDS600186FM200DIPS
18X8	7.25	12	29	150	HDS600188FM150DIPS
18X8	7.25	12	29	200	HDS600188FM200DIPS
18X10	7	12	27.25	150	HDS6001810FM150DIPS
18X10	7	12	27.25	200	HDS6001810FM200DIPS
18X12	8.5	12	26	150	HDS6001812FM150DIPS
18X12	8.5	12	26	200	HDS6001812FM200DIPS
18X14	8.5	12	24.25	150	HDS6001814FM150DIPS
18X14	8.5	12	24.25	200	HDS6001814FM200DIPS
18x16	8.5	12	22.25	150	HDS6001816FM150DIPS
18X16	8.5	12	22.25	200	HDS6001816FM200DIPS

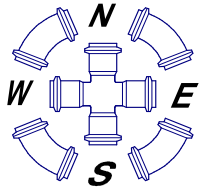

# SPECIFIED FITTINGS, INC

**164 W. SMITH RD**  
**BELLINGHAM, WA 98226**  
**888-734-8846 (T)**  
**888-734-8258 (F)**  
[spec@specfit.com](mailto:spec@specfit.com)

**483 STEVENSVILLE AIRPORT RD.**  
**STEVENSVILLE, MT 59870**  
**406-777-3466 (T)**  
**406-777-7181 (F)**  
[sales@specfit.com](mailto:sales@specfit.com)

[www.specfit.com](http://www.specfit.com)

## DIPS HDPE FABRICATED CONCENTRIC REDUCER DIMENSION CHART

SIZE	A	B	C	PRESSURE	
				CLASS	PART #
20X4	4.75	12	43.75	150	HDS600204FM150DIPS
20X4	4.75	12	43.75	200	HDS600204FM200DIPS
20X6	6.75	12	37.5	150	HDS600206FM150DIPS
20X6	6.75	12	37.5	200	HDS600206FM200DIPS
20X8	7.25	12	37	150	HDS600208FM150DIPS
20X8	7.25	12	37	200	HDS600208FM200DIPS
20X10	7	12	29	150	HDS6002010FM150DIPS
20X10	7	12	29	200	HDS6002010FM200DIPS
20X12	8.5	12	30	150	HDS6002012FM150DIPS
20X12	8.5	12	30	200	HDS6002012FM200DIPS
20X14	8.5	12	26	150	HDS6002014FM150DIPS
20X14	8.5	12	26	200	HDS6002014FM200DIPS
20X16	8.5	12	24.25	150	HDS6002016FM150DIPS
20X16	8.5	12	24.25	200	HDS6002016FM200DIPS
20X18	9.5	12	23.25	150	HDS6002018FM150DIPS
20X18	9.5	12	23.25	200	HDS6002018FM200DIPS
24X4	4.75	12	50	150	HDS600244FM150DIPS
24X4	4.75	12	50	200	HDS600244FM200DIPS

SIZE	A	B	C	PRESSURE	
				CLASS	PART #
24X6	6.75	12	46.75	150	HDS600246FM150DIPS
24X6	6.75	12	46.75	200	HDS600246FM200DIPS
24X8	7.25	12	39	150	HDS600248FM150DIPS
24X8	7.25	12	39	200	HDS600248FM200DIPS
24X10	7	12	37.25	150	HDS6002410FM150DIPS
24X10	7	12	37.25	200	HDS6002410FM200DIPS
24X12	8.5	12	32.5	150	HDS6002412FM150DIPS
24X12	8.5	12	32.5	200	HDS6002412FM200DIPS
24X14	8.5	12	30.5	150	HDS6002414FM150DIPS
24X14	8.5	12	30.5	200	HDS6002414FM200DIPS
24X16	8.5	12	28.75	150	HDS6002416FM150DIPS
24X16	8.5	12	28.75	200	HDS6002416FM200DIPS
24X18	9.5	12	27	150	HDS6002418FM150DIPS
24X18	9.5	12	27	200	HDS6002418FM200DIPS
24X20	9.5	12	25.25	150	HDS6002420FM150DIPS
24X20	9.5	12	25.25	200	HDS6002420FM200DIPS